



MANDRINI PORTAPINZA TIPO EOC
EOC COLLET CHUCK
MANDRINS A PINCES TYPE EOC
SPANNZAGENFUTTER EOC TYPE



DIN 69871 AD/B

DIN 6388

Bilanciato G.6,3 12.000 RPM

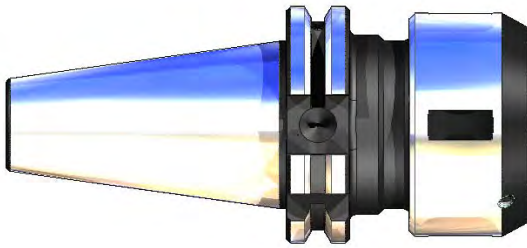

FIG. 1

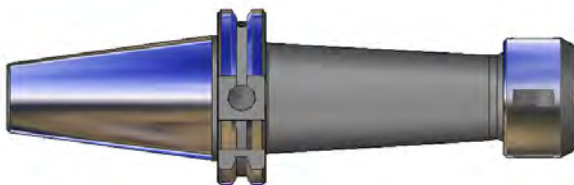
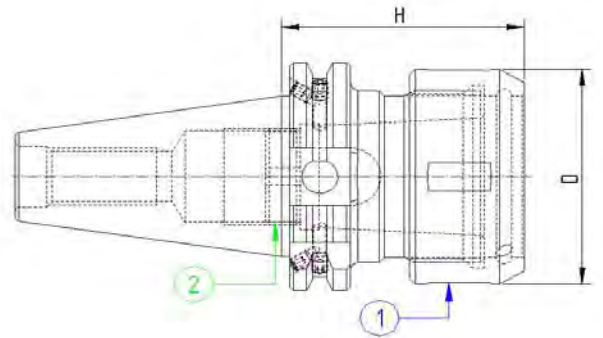
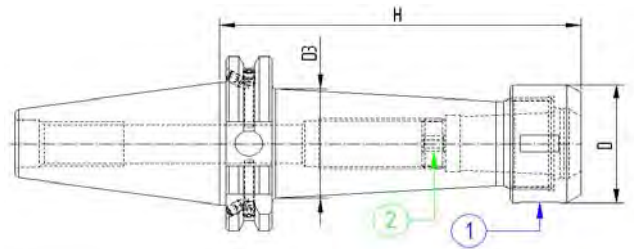

FIG. 2



Codice	ISO	Descrizione	H	D	D3	FIG.
140PO116	40	ISO40 DIN69871 P/P H70 EOC16	70	43	-	1
140PO125	40	ISO40 DIN69871 P/P H70 EOC25	70	60	-	1
140PO132	40	ISO40 DIN69871 P/P H80 EOC32	80	72	-	1
140PO216	40	ISO40 DIN69871 P/P H100 EOC16	100	43	-	1
140PO225	40	ISO40 DIN69871 P/P H100 EOC25	100	60	-	1
140PO232	40	ISO40 DIN69871 P/P H100 EOC32	100	72	-	1
140PO316	40	ISO40 DIN69871 P/P H130 EOC16	130	43	40	2
140PO325	40	ISO40 DIN69871 P/P H130 EOC25	130	60	49	2

----- Secondo fattibilità, fornibili su richiesta con cono ISO 30 -----

COMPONENTI - SPARE PARTS - PIECES DETACHEES - ERSATZTEILE

EOC	GHIERA	Q.tà	GRANO INT.	Q.tà
		1		1
16	916GHROS	1	101815801	1
25	925GHROS	1	102715901	1
32	932GHROS	1	102715901	1



MANDRINI PORTAPINZA TIPO EOC
 ER COLLET CHUCK
 MANDRINS A PINCES TYPE EOC
 SPANNZAGENFUTTER EOC TYPE



DIN 69871 AD/B

DIN 6388

Bilanciato G.6,3 12.000 RPM

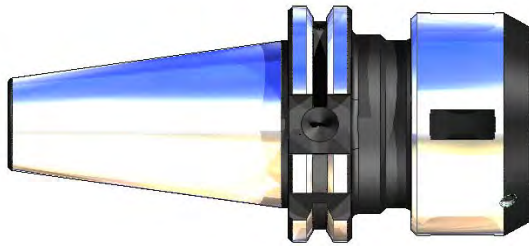

FIG. 1

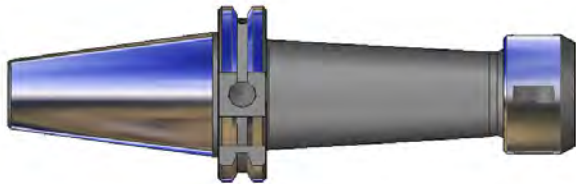
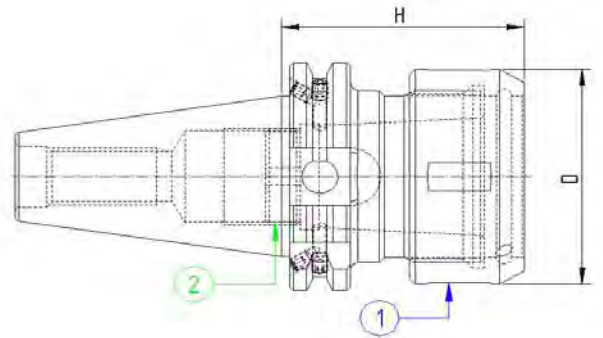
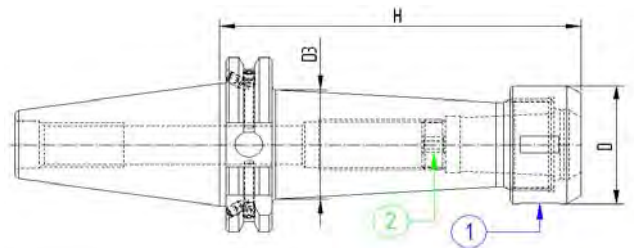

FIG. 2



Codice	ISO	Descrizione	H	D	D3	FIG.
150PO116	50	ISO50 DIN69871 P/P H70 EOC16	70	43	-	1
150PO125	50	ISO50 DIN69871 P/P H70 EOC25	70	60	-	1
150PO132	50	ISO50 DIN69871 P/P H80 EOC32	80	72	-	1
150PO216	50	ISO50 DIN69871 P/P H100 EOC16	100	43	-	1
150PO225	50	ISO50 DIN69871 P/P H100 EOC25	100	60	-	1
150PO232	50	ISO50 DIN69871 P/P H100 EOC32	100	72	-	1
150PO316	50	ISO50 DIN69871 P/P H130 EOC16	130	43	49	2
150PO325	50	ISO50 DIN69871 P/P H130 EOC25	130	60	58	2
150PO332	50	ISO50 DIN69871 P/P H130 EOC32	130	72	62	2

----- Secondo fattibilità, fornibili su richiesta con cono ISO 30 -----

COMPONENTI - SPARE PARTS - PIECES DETACHEES - ERSATZTEILE

EOC GHIERA Q.tà GRANO INT. Q.tà



16	916GHROS	1	101815801	1
25	925GHROS	1	102715901	1
32	932GHROS	1	102715901	1